

Trimapanel® U-values	
Depth 70 = 0.31 W/m²K. Depth 90 = 0.24 W/m²K. Depth 120 = 0.17 W/m²K.	
Junction 'psi' and 'fi' values	
With liner cut back $\psi = 0.011$ W/mK. $f = 0.977$	
Without liner cut back $\psi = 0.17$ W/mK. $f = 0.930$	
Stated calculation results are dependent on components being as shown. Computer modelled in accordance with EN ISO 10211	
	
Tata Steel retain the right to amend the construction and technical specifications shown on this drawing without prior notice.	
	
SALES TEL: 01244 892199 TECHNICAL TEL: 01244 892133 / 34	
www.tatasteelconstruction.com	
PROJECT Trimapanel® System Typical Details	
TITLE Internal Corner	
DRAWN BY JCA	SCALE NTS
APPROVED BY DA	TOLERANCES
DATE 22/11/10	DRG. No. W2-010-03-B

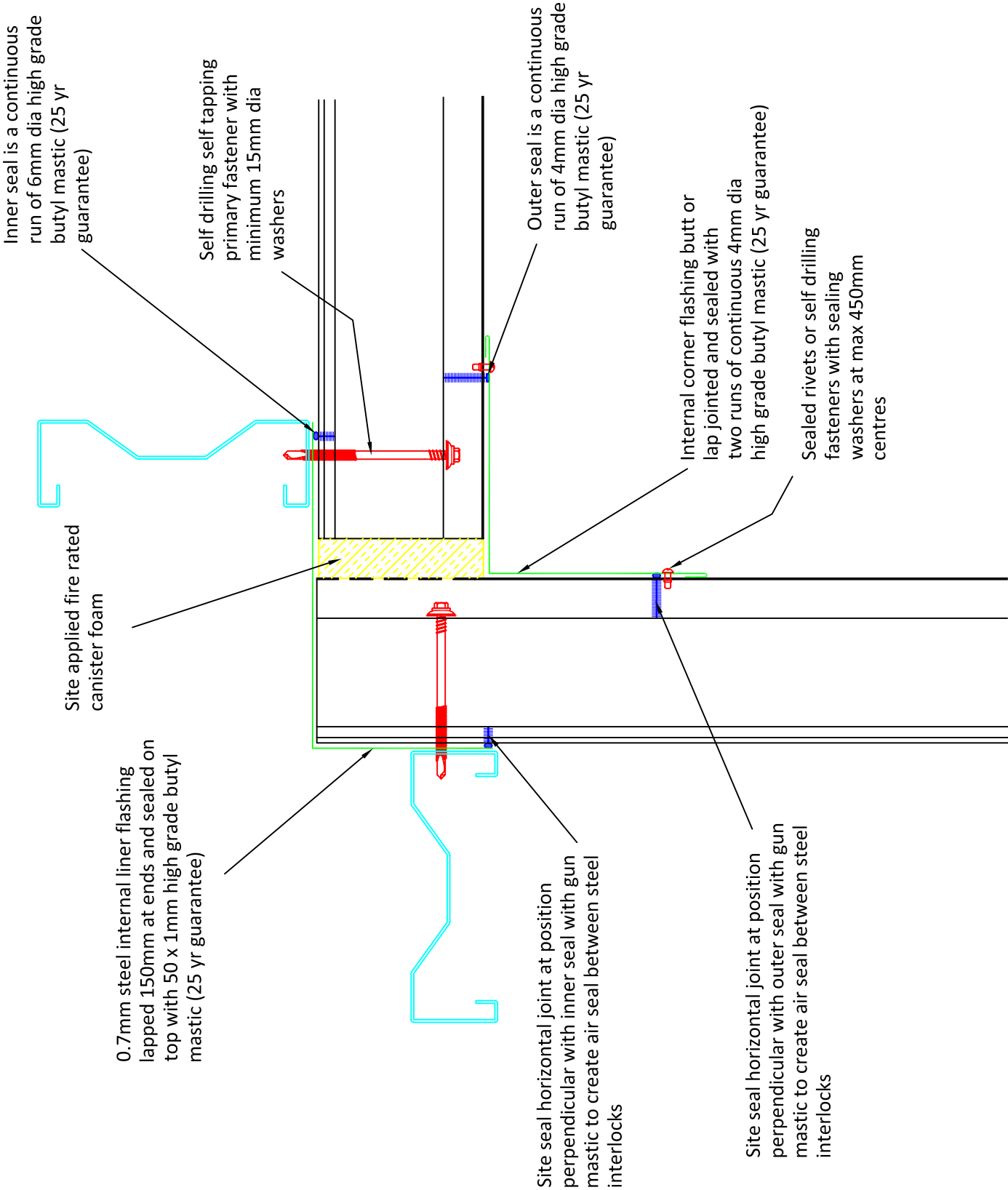

All support steelwork by others